

OPK

PL

POWER LIFTER



— Japan Quality —



FOUNDED 1934



OKUDAYA GIKEN CO., LTD.

OSAKA JAPAN

ESTABLISHED 1954

Manual Power Lifter (Standard Type)

This time-proven standard model has been redesigned for improved **safety** and **environmental friendliness**.

- Quick-lifting device (except H250-15L, H350-15, H350-15SU).
- All models include caster covers as standard accessories.
- Powerful foot-operated parking brake.
- Built-in automatic load check valve device for improved safety.

- Large, transparent guard panel for improved safety.
Manufactured using environmentally friendly polyethylene terephthalate (PET).
- Clean resin sprocket cover.
- Environmentally friendly lead-free paint.
- Compact, lightweight power lifter is capable of smaller turning radius.



Quick-lifting device

Stepping on the quick-lifting magic pedal triples the lifting speed, increasing the work efficiency of power lifter (with no load).



Caster cover



Sprocket cover



Lifting height: 1500 mm

PL-H250-15L
PL-H350-15



Stainless steel type
Lifting height: 1500 mm

PL-H350-15SU



Lifting height: 1500 mm

PL-H400-15L
PL-H500-15(L)
PL-H650-15



Lifting height: 1500 mm

PL-H 800-15
PL-H1000-15



Long-fork type
Lifting height: 1500 mm

PL-H 800-15L
PL-H1000-15L

Offers a versatile selection of attachments for a wide variety of requirements.

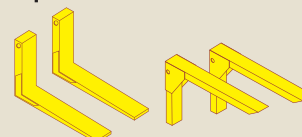

Thin-type fork

Inverted fork

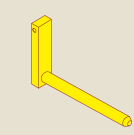

Ram fork

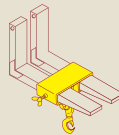

Sling hook

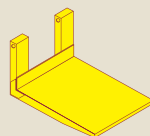
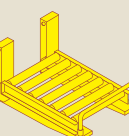
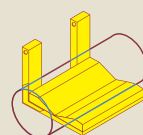

Table fork



Roller conveyor



Roll receiving fork

Manual Power Lifter (Standard Type)

Specifications	Capacity	Min. H (mm)	Max. H (mm)	Fork (mm)			Outrigger width (mm)		Overall length (mm)	Overall width (mm)	Overall height (mm)	Steering wheel Dia.φ×width (mm)	Load wheel Dia.φ×width (mm)	Power source	Number of lifting times	Net weight (kg)
				Length	Load center	Slide outer width	Outer width	Inner width								
Model	(kg)	A1	A	B	C	D	E1	E2	F	G	H					
PL-H250-15L	250	80 (95)	1,500	800	400	165~ 530	508	392	1,325	605	1,900	Rubber 150×45 Urethane 150×38	Urethane 80×38	Manual hydraulic pump	33 Reciproca- tion times	94
PL-H350-15	350			650	350				1,175							92
PL-H350-15SU				650	350	1,170	595	107								
PL-H400-15L	400			800	400	1,380	655	1,950	Rubber 150×45 Urethane 80×73	50〈18〉	144					
PL-H500-15	500			650	350	270~ 575					550	350	1,230		138	
PL-H500-15L				650	350	1,395	70〈25〉	157								
PL-H650-15	650	800		400	270~ 725	700	500	1,510	855	1,950	Urethane 80×73	Urethane 200×42	117 〈42〉		157	
PL-H800-15	800	1,000		500				1,710							245	
PL-H800-15L		1,000		800	400	1,000	500	1,510	1,710	855	1,950	Urethane 200×42	Urethane 80×73		117 〈42〉	255
PL-H1000-15	800			400	1,510											248
PL-H1000-15L	1,000			1,000	500											1,710

Manual Power Lifter (Standard/W Series)

PLW-H350-25	350	80 (95)	2,500	650	350	165~640	619	503	1,180	665	1,745	Rubber 150×45	Urethane 80×38	Manual hydraulic pump	82	150
PLW-H500-25	500			650	350	270~	750	550	1,350	830	1,785	Urethane 200×42	Urethane 80×73		120 (45)	230
PLW-H650-25	650			800	400	775			1,515							275

※ Minimum lifting height are shown in ()
on the condition that the forks are put on the legs.

※ Lifting times in () are quick-lifting times
on the condition that no loads are imposed.

Dimensions (PL-H Series)

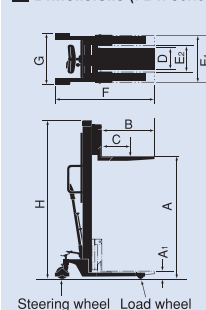

Steering wheel Load wheel

Battery-operated Power Lifter (Standard Type)

All models have been redesigned for improved **safety**, **environmental friendliness**, and **ease of maintenance**.

- Hoisting lever for easy up-and-down motion at the flip of a switch.
- Soft-up mechanism for flexible control of lifting speed.
- All models include caster covers as standard accessories.
- Built-in automatic load check valve device for improved safety.
- Large, transparent guard panel for improved safety.
- Clean resin sprocket cover.
- Integrated resin covers for component joints.
- Key switch ensures safety during lifting.
- Built-in LED indicator for easy checking of the remaining battery level.
- Battery charger for recharging at any time from a AC100V,200~240V power supply.

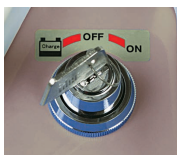

Key switch



Battery indicator

Battery bracket

Movable bracket allows easy maintenance.



Lifting height:1500 mm

PL-D250-15L
PL-D350-15



Lifting height:2500 mm



W Type

PLW-D500-25
PLW-D650-25



Lifting height:1500 mm



PL-D400-15L
PL-D500-15(L)
PL-D650-15



Lifting height:1500 mm



PL-D 800-15 (L)
PL-D1000-15 (L)

Soft-up mechanism (Patent pending)



A unique soft-lift valve keeps load from collapsing. This feature is useful for work requiring fine adjustments and when handling unstable loads.

Battery charger (Built-in type)



The automatic battery charger makes it easy to recharge the lifter. An indicator displays progress. (Cord length: Approx. 2m)

Emergency shutoff switch



'Emergency shutoff switch' is equipped for unexpected contingency.

Battery-operated Power Lifter (Standard Type)

Specifications	Capacity (kg)	Min. H (mm)	Max. H (mm)	Fork (mm)			Outrigger width (mm)		Overall length (mm)	Overall width (mm)	Overall height (mm)	Steering wheel Dia. φ × width (mm)	Load wheel Dia. φ × width (mm)	Battery	Rise time (sec.)	Net weight (kg)
				Length	Load center	Slide outer width	Outer width	Inner width								
Model		A1	A	B	C	D	E1	E2	F	G	H					
PL-D250-15L	250	80 (95)	1,500	800	400	165~530	508	392	1,325	605	1,900	Rubber 150×45	Urethane 80×38	DC12V 88AH/5HR	6~8	152
PL-D350-15	350			650	350				1,175						6~13	150
PL-D400-15L	400			800	400				1,380						9~11	202
PL-D500-15	500			650	350	270~575	550	350	1,230	655					8~15	195
PL-D500-15L	500			800	400				1,395						10~12	215
PL-D650-15	650	80 (97)	1,500	800	400				1,510	855	1,950	Urethane 200×42	Urethane 80×73	DC12V 96AH/5HR	7~16	215
PL-D800-15	800			1,000	500	270~725	700	500	1,710						15~19	322
PL-D800-15L	800			800	400				1,510							332
PL-D1000-15	1,000			800	400				1,510							325
PL-D1000-15L	1,000			1,000	500				1,710						15~21	335

Battery-operated Power Lifter (Standard/W Series)

PLW-D350-25	350	80	2,500	650	350	165~640	619	503	1,180	665	1,745	Rubber 150×45	Urethane 80×38	DC12V 88AH/5HR	11~14	195
PLW-D500-25	500	(95)				270~775	750	550	1,345	830	1,785	Urethane 200×42	Urethane 80×73	DC12V 96AH/5HR	12~16	280
PLW-D650-25	650			800	400				1,515						14~20	315
PLW-D350-30	350	80(95)	3,000	650	350	165~640	619	503	1,170	750	2,135	Rubber 150×45	Urethane 80×38	DC12V 88AH/5HR	13~17	220
PLW-D500-32	500	80	3,200			270~775			1,370	1,000	2,227	Urethane 200×42	Urethane 80×73	DC12V 96AH/5HR	15~22	350
PLW-D650-32	650			800	400		1,000	800	1,535						18~26	380

※Minimum lifting height are shown in () on the condition that the forks are put on the legs.

※Includes built-in automatic battery charger (AC100,200~240V).

Dimensions (PL-D/PLW-D Series)

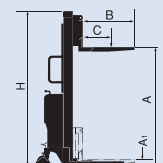

Steering wheel Load wheel

Manual Power Lifter (Economy Type)

This economy model offers basic functionality. All models are upgraded with a quick-lifting device. Includes a well-regarded pump pedal as a standard accessory.

- Built-in automatic load check valve device for improved safety.
- Transparent guard panel ensures wide field of vision.
- Compact, lightweight power lifter is capable of smaller turning radius.
- Sprocket cover.

Featuring two to three times the lifting speed

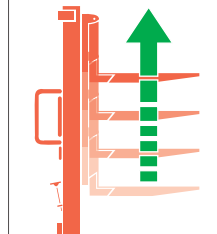

(Patented) Quick-lifting device (Built-in)

Increases the lifting speed of the fork two to three times for light loads, improving the working efficiency of the power lifter. A safety feature automatically switches the lifting speed to normal when the load exceeds a certain limit.

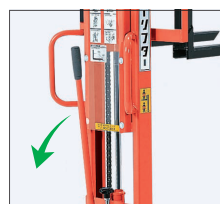

(Option) Pump handle

Mountable on all manual economy models.



Lifting height:1200 mm

PL-H200-12S



Lifting height:1200 mm

PL-H350-12S



Lifting height:1500 mm

PL-H350-15S



Lifting height:1500 mm

PL-H500-15S



Lifting height:1500 mm

PL-H650-15S



Manual Power Lifter (Economy Type)

Specifications Model	Capacity (kg)	Min. H (mm)	Max. H (mm)	Fork (mm)			Outrigger width(mm)		Overall length (mm)	Overall width (mm)	Overall height (mm)	Steering wheel Dia.φ×width (mm)	Load wheel Dia.φ×width (mm)	Power source	Number of lifting times	Net weight (kg)
				Length	Load center	Slide outer width	Outer width	Inner width								
PL-H200- 8S	200	75	850	550	300	135~	470	356	935	530	1,200	Rubber 125×38	Urethane 75×32	Hydraulic foot pedal	16 (8)	47
PL-H200-12S		(90)	1,200			165~					1,550				24 (12)	53
PL-H350-12S						530					1,600				55 (18)	84
PL-H350-15S	350	80	1,500	650	350	215~	550	396	1,170	575	1,900	Rubber 150×40	Urethane 80×38		69 (23)	89
PL-H500-12S	500	(95)	1,200			575					1,600				55 (18)	96
PL-H500-15S			1,500			575					1,900				69 (23)	103
PL-H650-15S	650			800	400	265~575		350	1,335		1,925		Urethane 80×75		104 (36)	125

※ Minimum lifting height is shown in () on the condition that the forks are put on the legs.
 ※ Economy types (PL-H350 to PL-H650) cannot be modified.

※ Lifting times in () are quick-lifting times on the condition that no loads are imposed.

Dimensions (PL-H-S Series)

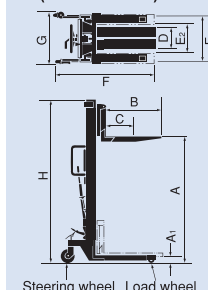

Steering wheel Load wheel

Battery-operated Power Lifter (Economy Type)

This battery-operated economy model supports flexible physical distribution.

- Hoisting lever for easy up-and-down motion at the flip of a switch.
- Battery-operated type suitable to any workplace.
- Parking brake.
- User-friendly battery meter with three-color graduations.
- Battery charger for recharging at any time from AC100V 200~240V power supply.



Sprocket cover
Clean, lightweight resin cover.



Lifting height:1200 mm

PL-D200-12S



Lifting height:1200 mm

**PL-D350-12S
PL-D500-12S**

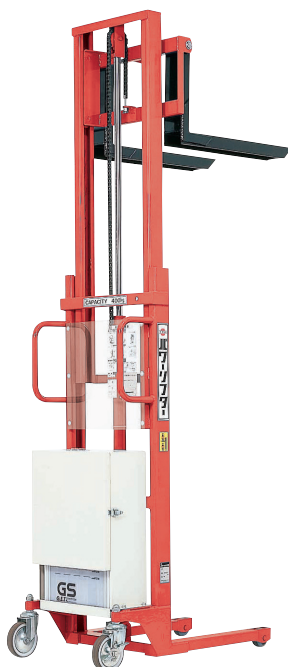

Lifting height:2150 mm W Type

**PLW-D250-21S
PLW-D400-21S**



Lifting height:1500 mm

PL-D350-15S



Lifting height:1500 mm

PL-D500-15S



Lifting height:1500 mm

PL-D650-15S

Operation push button



Momentary push buttons for raising and lowering the lifter stop operation when released.

Battery charger (Built-in type)



The automatic battery charger makes it easy to recharge the lifter. An indicator displays progress. (Cord length: Approx. 2 m)

Battery meter

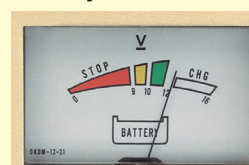

Green, yellow, and red graduations make it easy to check remaining battery level.

■ Battery-operated Power Lifter (Economy Type)

Specifications Model	Capacity (kg)	Min. H (mm)	Max. H (mm)	Fork (mm)			Outrigger width (mm)		Overall length (mm)	Overall width (mm)	Overall height (mm)	Steering wheel Dia. φ X width (mm)	Load wheel Dia. φ X width (mm)	Batte-ry	Rise time (sec.)	Net weight (kg)
				Length	Load center	Slide outer width	Outer width	Inner width								
PL-D200-12S	200	75 (90)	1,200	550	300	135~470	470	356	950	530	1,550	Rubber 125X38	Urethane 75X32	DC12V 28AH/5HR	6~8	96
PL-D350-12S	350					165~530	510	396	1,170	575	1,600			DC12V 88AH/5HR	6~10	100
PL-D350-15S		80 (95)	1,500	650	350						1,900			DC12V 40AH/5HR	7~13	138
PL-D500-12S	500		1,200			215~575	550	400	1,180	625	1,600	Rubber 150X40	Urethane 80X38	DC12V 88AH/5HR	8~12	137
PL-D500-15S											1,900				10~14	157
PL-D650-15S	650		1,500	800	400	265~575		350	1,335		1,925		Urethane 80X75		9~15	178

■ Specifications for Battery-operated Power Lifter (Economy/W Series)

PLW-D250-21S	250	80 (95)	2,150	650	350	165~530	510	396	1,185	575	1,615	Urethane 150X35	Urethane 75X32	DC12V 88AH/5HR	13~17	153
PLW-D400-21S	400					215~575	550	400	1,195	625			Urethane 80X38		14~20	178

※ Minimum lifting height are shown in () on the condition that the forks are put on the legs.

※ Economy types (PL-H350 to PL-H650) cannot be modified.

※ Includes built-in automatic battery charger (AC100,200~240V).

■ Dimensions (PL-D-S Series)

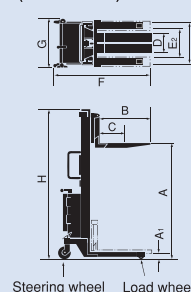

Incorporates a drive device for superior maneuverability.

- An FET chopper system (electronically controlled continuously variable transmission) with new functionality offers flexible drive speed control for smooth operation.
- Hoisting lever for easy up-and-down motion at the flip of a switch.
- Soft up mechanism for flexible control of lifting speed.
- All models include caster covers as standard accessories.
- Built-in automatic load check valve device for improved safety.
- Large, transparent guard panel for improved safety.
- Lightweight power lifter is capable of smaller turning radius, making it ideal for work in narrow passages and on second floors.
- Electric brake.
- Parking brake.



The Super Unit transforms a handcart into a self-propelled cart.

- An FET chopper system (electronically controlled continuously variable transmission) with new functionality offers flexible drive speed control for smooth operation.
- Floor-friendly no puncture tires for soft running performance.
- Compact, high-power design.
- Easy to operate. Just operate the "Run" switch for a smooth launch.
- Safety switch for worker safety.
- Emergency stop switch equipped.



(Option)



Safety cover

Drive U

The Drive U transforms a handcart into a self-propelled cart.



Lifting height :1500 mm

PL-U350-15

SU25
SU40

Self-propelled Power Lifter U

Specifications Model	Capacity (kg)	Min. H (mm)	Max. H (mm)	Fork (mm)			Outrigger width (mm)		Overall length (mm)	Overall width (mm)	Overall height (mm)	Drive speed (km/h)		Minimum turning radius (mm)	Brake	Battery	Rise time (sec.)	Net weight (kg)
				Length	Load center	Slide outer width	Outer width	Inner width				With no load	With load					
PL-U350-15	350	80 (95)	1,500	650	350	165~530	508	392	1,335	795	1,900	0~2.4	0~2.2	1,100	Electro-Magnetic Brake	DC12V 88AH/5HR	7~9	172
PL-U500-15	500			650	350	270~575	550	350	1,395	845	1,950			1,160			9~12	217
PL-U650-15	650			800	400				1,560					1,250				237

※Minimum lifting height are shown in () on the condition that the forks are put on the legs.

※Includes built-in automatic battery charger (AC100,200~240V).

Drive U

Specifications Model	Overall length (mm)	Overall width (mm)	Overall height (mm)	Motor	Drive wheel Dia.φ x width (mm)	Brake	Control device	Drive speed selection switch	Net weight (kg)
U-150	310	415	1,170	DC12 V 150 W Rated at 20 minutes	Urethane 160 x 36	Electro-Magnetic Brake	FET Chopper System	Two Steps (High/Low)	21

Dimensions (PL-U Series)

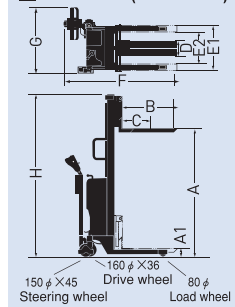

Super Drive Unit

Specifications Model	Max. traction mass (kg)	Traction (N)	Overall length (mm)	Overall width (mm)	Overall height (mm)	Travel device		Control device	Drive speed (km/h)		Climbing ability	Drive wheel	Net weight (kg)
						Motor	Brake		With no load	With load			
SU25	1,000	441 (45kg·f)	435	415	1,275	DC12V250W	Electro-magnetic brake	FET chopper system	0~3.6	0~2.5	4°	Dia. 250 Self-sealing tire	72
SU40	1,500	686 (70kg·f)				DC12V400W			0~2.6	0~2.0			76

※A battery or charger is not included.

Santo Picker

- Make picking work at higher level (around 3M) easy.
- One-touch breaking system for improving workability and safety.
- Compact design allows free movement in warehouse passages.
- Built-in automatic battery charger (AC100,200~240V)
- Parking brake equipped.



Automatic battery charger
(Built-in)

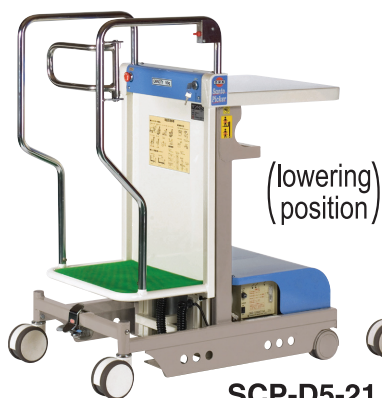

SCP-D5-21

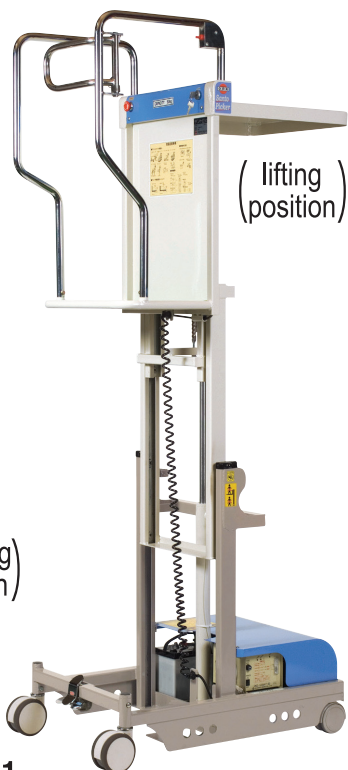

(lifting
position)



PPLW-D200-27

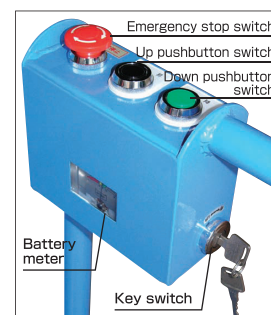

Dimensions

Santo Picker

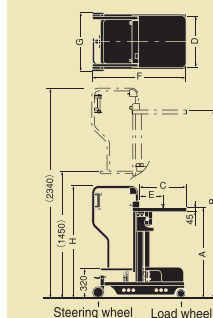

Picking Power Lifter

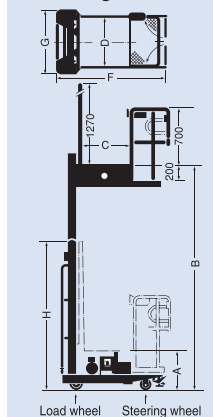

Santo Picker

Specifications	Capacity	Min. H		Table Size(mm)			Overall length (mm)	Overall width (mm)	Overall height (mm)	Steering wheel Dia.φ × width (mm)	Load wheel Dia.φ × width (mm)	Battery	Rise time (sec.)	Fall time (sec.)	Net weight (kg)
		(mm)	(mm)	Length	width	Load center									
Model	(kg)	A	B	C	D	E	F	G	H						
SCP-D5-21	table : 50 Step : 100	970	2,100	500	550	250	1,000	620	1,200	Double Wheel Urethane 125×73	Double Wheel Elastomer 100×66	DC12V 28AH/ 5HR	6~8	10~13	135

※ Includes built-in automatic battery charger (AC100,200~240V).

Picking Power Lifter

Specifications	Capacity	Min. H		Loading platform dimension (mm)		Overall length (mm)	Overall width (mm)	Overall height (mm)	Steering wheel Dia.φ × width (mm)	Load wheel Dia.φ × width (mm)	Battery	Parking brake
		(mm)	(mm)	Length	Width							
Model	(kg)	A	B	C	D	F	G	H				
PPLW-D200-27	200	470	2,730	625	600	1,335	750	1,745	Urethane 130×35	Urethane 150×38	DC12V 88AH/5HR	Two Areas

Rise time	Fall time	Net weight
(sec.)	(sec.)	(kg)
9~15	13~22	270

※ Max. load mass (kg) refers to the movable load of the power lifter including the operator.
※ Includes built-in automatic battery charger (AC100,200~240V).



Built-in battery charger (AC100,200~240V).
(Cord length: Approx. 1.5m)

Special Lifter

Mini Jib Crane Type (for 80 kg Light Loads)

This model is designed for mounting and dismounting machine tool jigs (for machining and electrical discharge processing) and workpieces. Ideal for replacing broken wires with new ones.



Jib Crane Type (for 200-kg Medium Loads)

This dedicated machine is useful for lifting and hanging work.



Truck on Power Lifter



When loading onto a truck



Power Lifter for Mini Jib Crane Type

Specifications Model	Capacity (kg)	Min. H (mm)	Max. H (mm)	Arm (mm)		Over hanging (mm)	Overall length (mm)	Overall width (mm)	Overall height (mm)	Steering wheel Dia.φ × width (mm)	Load wheel Dia.φ × width (mm)	Number of lifting times	Net weight (kg)
				Load center	Slide stroke								
PL-H350-12G	80	640	1,740	900	300	400	1,190	575	1,600	Rubber 150×40	Urethane 75×32	58	Approx. 150 kg (including a balance weight of 60kg)
PL-H500-12G	120	640	1,740	900	300	400	1,210	625	1,600	Rubber 150×40	Urethane 80×38	55 <18>	Approx. 200 kg (including a balance weight of 60kg)

Power Lifter for Mini Jib Crane Type

PL-H500-15G	200	580	2,000	960	700	400	1,585	695	1,950	Stereo 150×45	Urethane 150×45	50 <18>	260
-------------	-----	-----	-------	-----	-----	-----	-------	-----	-------	------------------	--------------------	------------	-----

Truck on Power Lifter

Specifications Model	Capacity (kg)	Min. H (mm)	Max. H (mm)	Fork (mm)			Outrigger width (mm)		Overall length (mm)	Overall width (mm)	Overall height (mm)	Steering wheel Dia.φ × width (mm)	Load wheel Dia.φ × width (mm)	Number of lifting times	Net weight (kg)
				Length	Load center	Slide outer width	Outer width	Inner width							
PL-H200-12T	200	75 (90)	1,200	550	300	145~470	470	356	945	530	1,550	Rubber 125×38	Urethane 75×32	24<12>	59

※ Lifting times in < > are quick-lifting times on the condition that no loads are imposed.

Reach Type

This counter-balanced model performs when there is no clearance under the load being transferred.



Power Lifter for Reach Type

Model	PL-H350-15R
Max. load mass (kg)	350
Lifting height (mm)	80~1,500

Used for Replacement of Pillow Packing Rolls (Turntable Type)



Available on request

Lifter for Replacement of Pillow Packing Rolls

Model	PL-H200-12SR
Max. load mass (kg)	60
Lifting height (mm)	210~1,300

Used for Roll Reversal

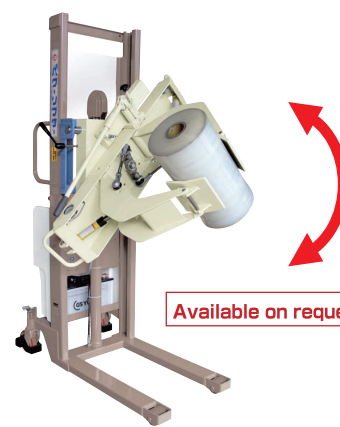

Available on request

Lifter for Roll Reversal

Model	PL-D650-15RC
Max. load mass (kg)	300
Roll diameter (mm)	φ300~φ800

Created by Highly Experienced Hydraulic Equipment Makers.

Originality Produces Know-how



OKUDAYA GIKEN CO., LTD.

263Tanjo Mihara-ku Sakai-city, Osaka 587-0011 JAPAN.
TEL 81-72-361-7861 FAX 81-72-362-2102

URL : <http://www.opk.co.jp>



* Products with special specifications besides those with standard specifications are manufactured as well. Feel free to contact OKUDAYA GIKEN.
The specifications described in this catalog are subject to change without notice for product improvement.
* The colors of actual products may be more or less different from those printed in this catalog.

All rights reserved.

As of December 2023

GMD03-01.23.06.1S

Cutting-edge drive device ensures mobility and power.

- An FET chopper system (electronically controlled continuously variable transmission) with new functionality offers flexible drive speed control for smooth operation.
- Floor-friendly no puncture tires for soft running performance.
- Compact, high-power design.
- Easy to operate. Just operate the "Run" switch for a smooth launch.
- Safety switch for worker safety.
- All models include caster covers as standard accessories (except SU1500-14).
- Large, transparent guard panel for improved safety.
- Built-in automatic load check valve device for improved safety.
- Integrated resin covers for component joins.



Caster cover



Lifting height:1500 mm

PL-SU500-15



Lifting height:1500 mm

PL-SU650-15

(Option)



Safety cover



Spring caster
grounding type



Lifting height:1500 mm

PL-SU500-15 PL-SU650-15



Lifting height:1500 mm

PL-SU 800-15 (L) PL-SU1000-15 (L)

Soft-up mechanism
(Patent pending)



Battery charger
(Built-in type)



Emergency shutoff switch



Battery indicator



Key switch



Self-propelled Power Lifter SU

Specifications Model	Capacity (kg)	Min. H	Max. H	Fork (mm)			Outrigger width (mm)		Overall length (mm)	Overall width (mm)	Overall height (mm)	Drive speed (km/h)		Minimum turning radius (mm)	Brake	Battery	Rise time (sec.)	Net weight (kg)
		(mm)	(mm)	Length	Load center	Slide outer width	Outer width	Inner width				With no load	With load					
		A1	A	B	C	D	E1	E2	F	G	H							
PL-SU500-15	500	80	1,500	650	350	270~	550	350	1,510	860	1,950	0	0	1,350	Electro- magnetic brake	DC12V 100AH/ 5HR	8~11	280
PL-SU650-15	650	(95)		800	400	575			1,680			1,450	9~12	300				
PL-SU800-15	800	80		1,000	500	270~	700	500	1,730	930		3.6	2.5	1,680			15~19	412
PL-SU800-15L																		
PL-SU1000-15	990	(97)		800	400	725			1,730								15~21	415
PL-SU1000-15L												1,930						
PL-SU1500-14	1,500	80(135)	1,400	1,000	500	230~800	800	600	2,010	970		0~2.6	0~1.5	1,710			12~25	580

※Minimum lifting height are shown in () on the condition that the forks are put on the legs.

※Includes built-in automatic battery charger (AC100,200~240V).

Dimensions (PL-SU Series)

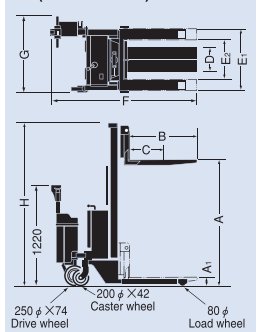

- An FET chopper system (electronically controlled continuously variable transmission) with new functionality offers flexible drive speed control for smooth operation.
- Floor-friendly no puncture tires for soft running performance.
- Compact, high-power design.
- Easy to operate. Just operate the "Run" switch for a smooth launch.
- Safety switch for worker safety.
- All models include caster covers as standard accessories.
- Large, transparent guard panel for improved safety.
- Built-in automatic load check valve device for improved safety.
- Integrated resin covers for component joints.
- Emergency stop switch.



Lifting height:2500 mm



PLW-SU400-25
PLW-SU500-25

- Safe-start function for smooth launches.
- Just operate the "Run" switch to launch the lifter and release to stop.
- Safe design automatically reduces the lifter's drive speed when lifting the load 400 mm or more from the floor.
- Powerful built-in electromagnetic brake device.
- Battery meter with three-color graduations.
- Safety switch for worker safety.
- Emergency shutoff device.



Lifting height:1500 mm

PL-S 800-15
PL-S1000-15

Walkie type stacker: BPL series as Anty ac series.

- AC inverter allows the delicate speed control by the accelerator.
- Regenerative braking system realize the smooth starting and stopping.
- Sealed battery is maintenance free.
- Small turning radius for narrow location.
- Built-in automatic battery charger (AC100,200~240V).
- Emergency stop switch equipped.



Lifting height:1500 mm

BPL-1000-15

Self-propelled Power Lifter SU (W Series)

Specifications Model	Capacity (kg)	Min. H	Max. H	Fork (mm)			Outrigger width (mm)		Overall length (mm)	Overall width (mm)	Overall height (mm)	Drive speed (km/h)		Minimum turning radius (mm)	Brake	Battery	Rise time (sec.)	Net weight (kg)				
		(mm)	(mm)	Length	Load center	Slide outer width	Outer width	Inner width				With no load	With load									
		A1	A	B	C	D	E1	E2	F	G	H											
PLW-SU400-25	400	80	2,500	650	350	270~775	750	550	1,595	980	1,830	0	0	1,480	Electro-magnetic brake	DC12V 120AH/5HR	12~16	365				
PLW-SU500-25	500	(95)		800	400		1,760	3.6	2.5			1,580	400									
PLW-SU650-25	650	80		270~825	800	600	1,770	0	0			1,690	1,835	3.5			2.4	1,690	14~20	507		
PLW-SU650-25L							1,970	3.5	2.4		517											
PLW-SU800-25	800	800					400	1,770	1,835		3.5	2.4								1,690	18~27	510
PLW-SU800-25L		1,000					500	1,970														520

※ Minimum lifting height are shown in () on the condition that the forks are put on the legs.

※ Includes built-in automatic battery charger (AC100,200~240V).

Dimensions (PLW-SU Series)

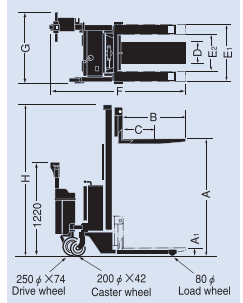

Self-propelled Power Lifter (PL-S Series)

Specifications Model	Capacity (kg)	Min. H (mm)	Max. H (mm)	Fork (mm)			Outrigger width (mm)		Overall length (mm)	Overall width (mm)	Overall height (mm)	Drive speed (km/h)		Minimum turning radius (mm)	Brake	Battery	Rise time (sec.)	Net weight (kg)
				Length	Load center	Slide outer width	Outer width	Inner width				With no load	With load					
PL-S 800-15	800	80	1,500	800	400	270~	700	500	1,685	775	1,950	High speed: 2.9 Low speed: 2.5	High speed: 2.2 Low speed: 1.6	1,650	Electro-magnetic brake	DC12V 120AH/5HR	15~19	447
PL-S1000-15	990	(97)		800	400	725			1,685	775	1,950	High speed: 2.9 Low speed: 2.5	High speed: 2.2 Low speed: 1.6	1,650			15~21	450
PL-SW500-25	500	80	2,500	650	350	270~	750	550	1,520	805	1,830	High speed: 2.9 Low speed: 2.4	High speed: 2.4 Low speed: 1.9	1,400			12~16	390
PL-SW650-25	650	(95)		800	400	775			1,690			High speed: 2.9 Low speed: 2.4	High speed: 2.4 Low speed: 1.9	1,510			14~20	422

※ Minimum lifting height are shown in () on the condition that the forks are put on the legs.

※ Includes built-in automatic battery charger (AC100,200~240V).

Dimensions (PL-S Series)

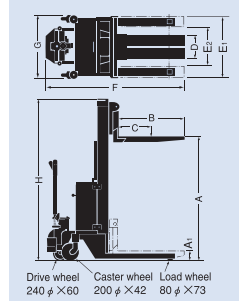

Self-propelled Power Lifter (BPL Series)

Specifications Model	Capacity (kg)	Min. H (mm)	Max. H (mm)	Fork (mm)			Stand Fork (mm)		Overall length (mm)	Overall width (mm)	Overall height (mm)	Drive speed (km/h)		Minimum turning radius (mm)	Brake	Sealed Battery	Rise time (sec.)	Net weight (kg)
				Length	Load center	Slide outer width	Outer width	Inner width				With no load	With load					
BPL-1000-15	990	80	1,500	800	400	270~725	700	500	1,850	775	1,950	0~4.0	0~3.5	1,680	Regenerative Braking + Electro-magnetic brake	DC12V 100AH/5HR X2	12~18	625
BPL-1000-15L	990	(97)		1,000	500	725			2,050			0~4.0	0~3.5	1,880			14~20	645
BPL-1500-14	1,500	80 (135)	1,400	1,000	500	230~800	800	600	2,095	850	1,835	0~3.2	0~3.0	1,890			12~20	790
BPLW-650-25	650	80 (97)	2,500	800	400	270~825			1,860			0~4.0	0~3.5	1,670			14~20	735

※ Minimum lifting height are shown in () on the condition that the forks are put on the legs.

※ Includes built-in automatic battery charger (AC100,200~240V).

※ Overall length will be longer approx. 410mm more than shown above while unfolding the step.

Dimensions (BPL Series)

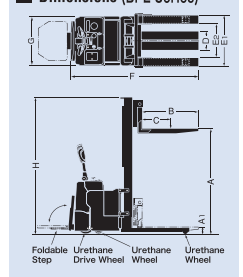

This new series of wide-type power lifter models supports 1,100 mm double pallets.

- Wide-type power lifter models are useful for stacked pallets.
- Select from three models (manual, battery-driven, and self-propelled) according to your application.
- All models include caster covers as standard accessories (except SU1000-15J).
- Powerful foot-operated parking brake.
- Built-in automatic load check valve device for improved safety.
- Large, transparent guard panel for improved safety.

Manufactured using environmentally friendly polyethylene terephthalate (PET).



PL-H200-15J
PL-H300-15J
PL-H400-15J

※The image shown above is "PL-H200-15J".



PL-D 200-15J
PL-D 300-15J
PL-D 400-15J

※The image shown above is "PL-D1000-15J".



PL-SU 800-15J
PL-SU1000-15J

※The image shown above is "PL-SU1000-15J".

(Option)



Safety cover



Spring caster grounding type

Manual Power Lifter (Wide Series)

Specifications Model	Capacity (kg)	Min. H (mm)	Max. H (mm)	Fork (mm)			Outtrigger width (mm)		Overall length (mm)	Overall width (mm)	Overall height (mm)	Steering wheel Dia. φ × width (mm)	Load wheel Dia. φ × width (mm)	Power source	Number of lifting times (sec.)	Net weight (kg)
				Length	Load center	Slide outer width	Outer width	Inner width								
PL-H200-15J	200	80	1,500	1,000	550	165~530	1,316	1,200	1,525	1,316	1,900	Rubber 150×45	Urethane 80×38	Manual hydraulic pump	33 reciprocation times	112
PL-H300-15J	300					270~575	1,400		1,580	1,400	1,950		Urethane 80×73		50 (18)	165
PL-H400-15J	400					270~575	1,400		1,595	1,400	1,950		80×73		70 (25)	185

Battery-operated Power Lifter (Wide Series)

Specifications Model	Capacity (kg)	Min. H (mm)	Max. H (mm)	Fork (mm)			Outtrigger width (mm)		Overall length (mm)	Overall width (mm)	Overall height (mm)	Steering wheel Dia. φ × width (mm)	Load wheel Dia. φ × width (mm)	Battery	Rise time (sec.)	Net weight (kg)
				Length	Load center	Slide outer width	Outer width	Inner width								
PL-D 200-15J	200	80	1,500	1,000	550	165~530	1,316	1,200	1,525	1,316	1,900	Rubber 150×45	Urethane 80×38	DC12V 88AH/5HR	7~9	170
PL-D 300-15J	300					270~575	1,400		1,580	1,400	1,950		Urethane 80×73		8~11	222
PL-D 400-15J	400					270~575	1,400		1,595	1,400	1,950		Urethane 80×73		9~12	242
PL-D 800-15J	800					270~725	1,370	1,370	1,710	1,370	1,950	Urethane 200×42	Urethane 150×45	DC12V 96AH/5HR	15~21	355
PL-D1000-15J	1,000	85				280~725	1,370		1,730	1,370	1,950					

※Includes built-in automatic battery charger (AC100,200~240V).

Self-propelled Power Lifter (Wide Series)

Specifications Model	Capacity (kg)	Min. H (mm)	Max. H (mm)	Fork (mm)			Outtrigger width (mm)		Overall length (mm)	Overall width (mm)	Overall height (mm)	Steering wheel Dia. φ × width (mm)	Load wheel Dia. φ × width (mm)	Drive speed (km/h)		Minimum turning radius (mm)	Brake	Battery	Rise time (sec.)	Net weight (kg)
				Length	Load center	Slide outer width	Outer width	Inner width						With no load	With load					
PL-SU 800-15J	800	80	1,500	1,000	550	270~725	1,370	1,200	1,960	1,370	1,950	Urethane 200×42 Spring Grounding 150×38×2	Urethane 150×45	0~3.6	0~2.5	1,780	Electro-magnetic brake	DC12V 120AH/5HR	15~19	435
PL-SU1000-15J	990	85				280~725	1,370	1,200	1,970	1,370	1,950					1,800				500

※Includes built-in automatic battery charger (AC100,200~240V).

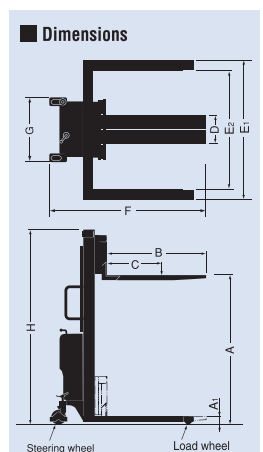

Drum Handler

- The drum handler can grip and handle a drum which is positioned vertically, horizontally, or near wall.
- Open drum also can be gripped and handled.
- Chuck a drum and rotate 180 degrees to forward.
- Parking brake equipped.
- Safety valve equipped with the hydraulic pump to prevent overloading.



DL-H300-6DT



PL-H300-12DT

Drum Carrier

- Easy chucking device operation.
- Easy ascending operation by hydraulic pump handle.
- Suitable for double stacking of drums.
- Parking brake equipped.
- Overload checking valve equipped.



PL-H300-14

Drum Porter

- Suitable for drum carrying operation without rotating.
- One-touch easy chucking device.
- Overload checking valve equipped.
- Parking brake equipped.



DL-300-30
DL-300-45

■ Dimensions

■ Drum Handler

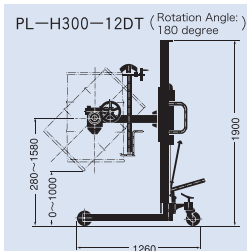
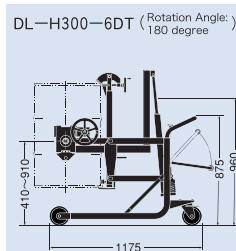

■ Drum Carrier

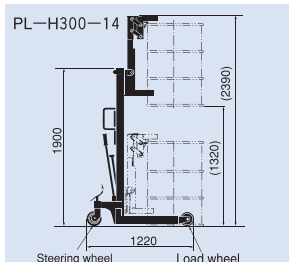

■ Drum Porter

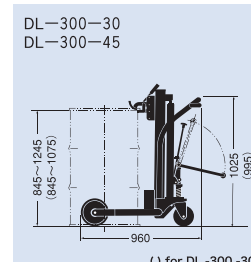

■ Drum Handler

Specifications	Capacity	Drum Dimension	Lifting Height	Overall	Overall	Overall	Load wheel	Steering wheel	Number	Net
Model	(kg)	φ × Height (mm)	[Bottom of a Drum] (mm)	length (mm)	width (mm)	height (mm)	φ × width (mm)	φ × width (mm)	of lifting times	weight (kg)
PL-H300-12DT	300	570×900	0~1,000 (135° Tilting) 0~1,250 (90° Tilting)	1,260	1,040	1,900	Urethane 150×38-2	Rubber 150×45-2	40	147
DL-H300- 6DT	300	570×900	0~350 (135° Tilting) 0~600 (90° Tilting)	1,210	1,050	975	Urethane 150-2	Polybutadiene Rubber 150-2	19	105

■ Drum Carrier

Specifications	Capacity	Drum Dimension	Lifting Height	Overall	Overall	Overall	Load wheel	Steering wheel	Number	Net
Model	(kg)	φ × Height (mm)	[Bottom of a Drum] (mm)	length (mm)	width (mm)	height (mm)	φ × width (mm)	φ × width (mm)	of lifting times	weight (kg)
PL-H300-14	300	570×900	0~1,320	1,220	820	1,900	Urethane 150×38	Rubber 150×45	33 Reciprocation times	138

■ Drum Porter

Specifications	Capacity	Drum Dimension	Lifting Height	Overall	Overall	Overall	Load wheel	Steering wheel	Number	Net
Model	(kg)	φ × Height (mm)	[Bottom of a Drum] (mm)	length (mm)	width (mm)	height (mm)	φ × width (mm)	φ × width (mm)	of lifting times	weight (kg)
DL-300-30	300	570×900	0~ approx 230	960	890	995	Polybutadiene Rubber 200-2	Polybutadiene Rubber 150-2	13	62
DL-300-45			0~ approx 400			1,025			20	63